

Survey No. 1

Lot. 8. Divided into timber lots. as per plot filed in the Register of Deeds office
Stakes placed at corners and lines blazed

Survey No. 2

Lot. 7. Divided into timber lots as per plot filed in the Register of Deeds office
Stakes placed at corners and lines blazed

28

29

30

31

32

33

34

35

36

SURVEY No. 1.

Section 29

Town 108

Range 40

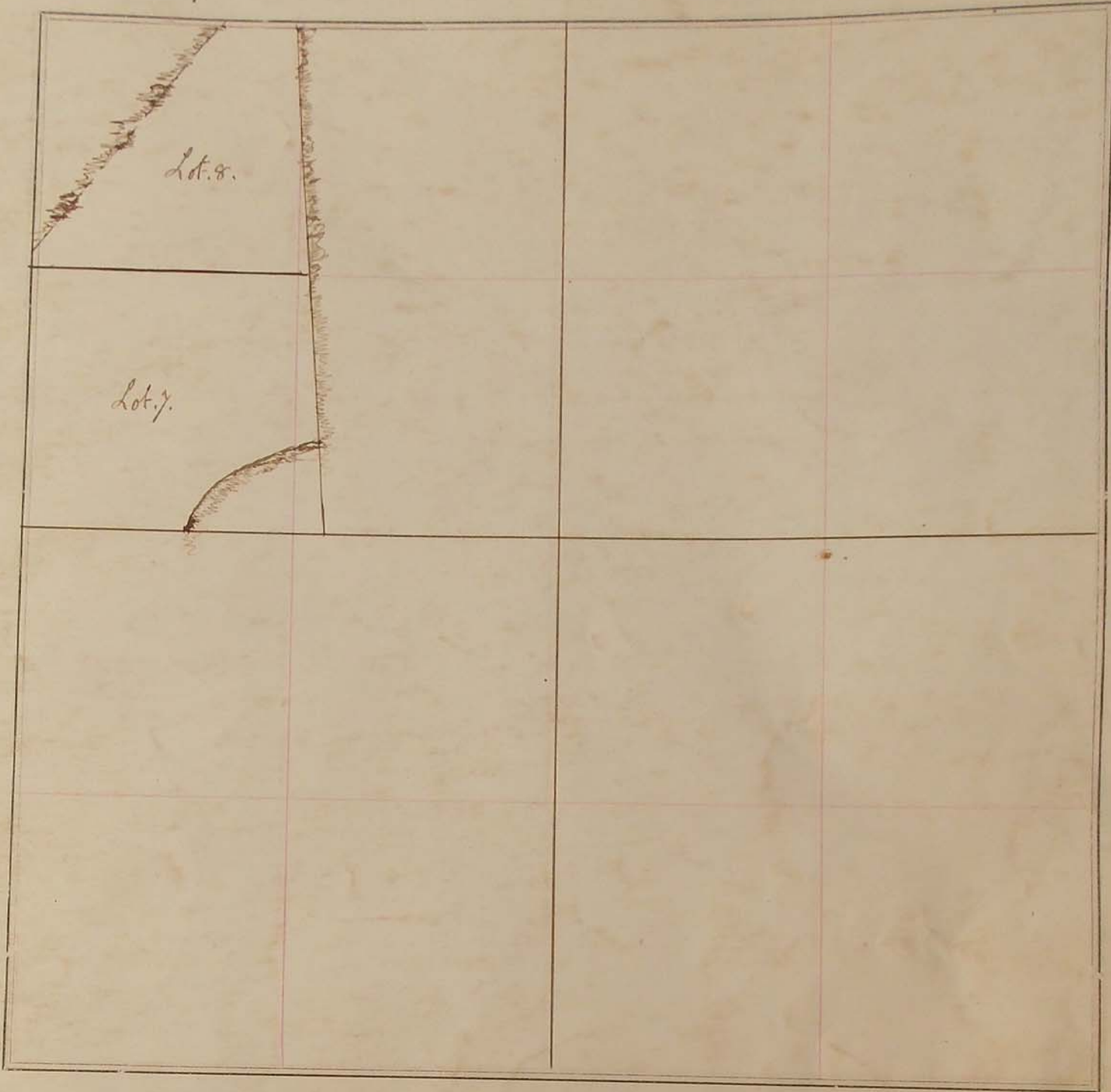

FIELD NOTES.

Survey No 1

Lot 8. Divided into timber lots, as per plat filed in Register of deeds office. Stakes placed at corners, and lines blazed.

Survey No 2.

Lot 7. Divided into timber lots, as per plat filed in Register of deeds office. Stakes placed at corners and lines blazed.

SURVEY No. 24

Section 29 Town 108 Range 40



FIELD NOTES.

Bearing Trees, Meander Lines

- 35 Burr Oak, 16" S. 57 1/2 E. 7.74. Stone mound
- 36 Burr Oak 14" N. 3 1/2 E. 2.8; Ash 5" S. 27 1/2 W. 1.77
- 37 Ash, 5" N. 39 1/2 E. 4.1. Elm 14" S. 42 E. 1.48
- 40 Ash 4" N. 8 1/2 E. 1.7 Br. Oak 14" S. 67 E. 1.80
- 10 Br Oak 12" N. 47 E. 5.53 Elm 4" N. 15 1/2 W. 3.37
- 11 Br Oak 16" S. 16 1/2 E. 1.7 Br Oak 7" S. 50 1/2 W. 5.6

B. W. Woodstock